

SITE
Dream Valley

Project By:

NEW SNEHA
 BUILDERS & DEVELOPERS

JB
 BUILDERS & REALTORS

Dream Valley

4 BHK Triplex Luxury Villas
 @ KURNOOL CITY.

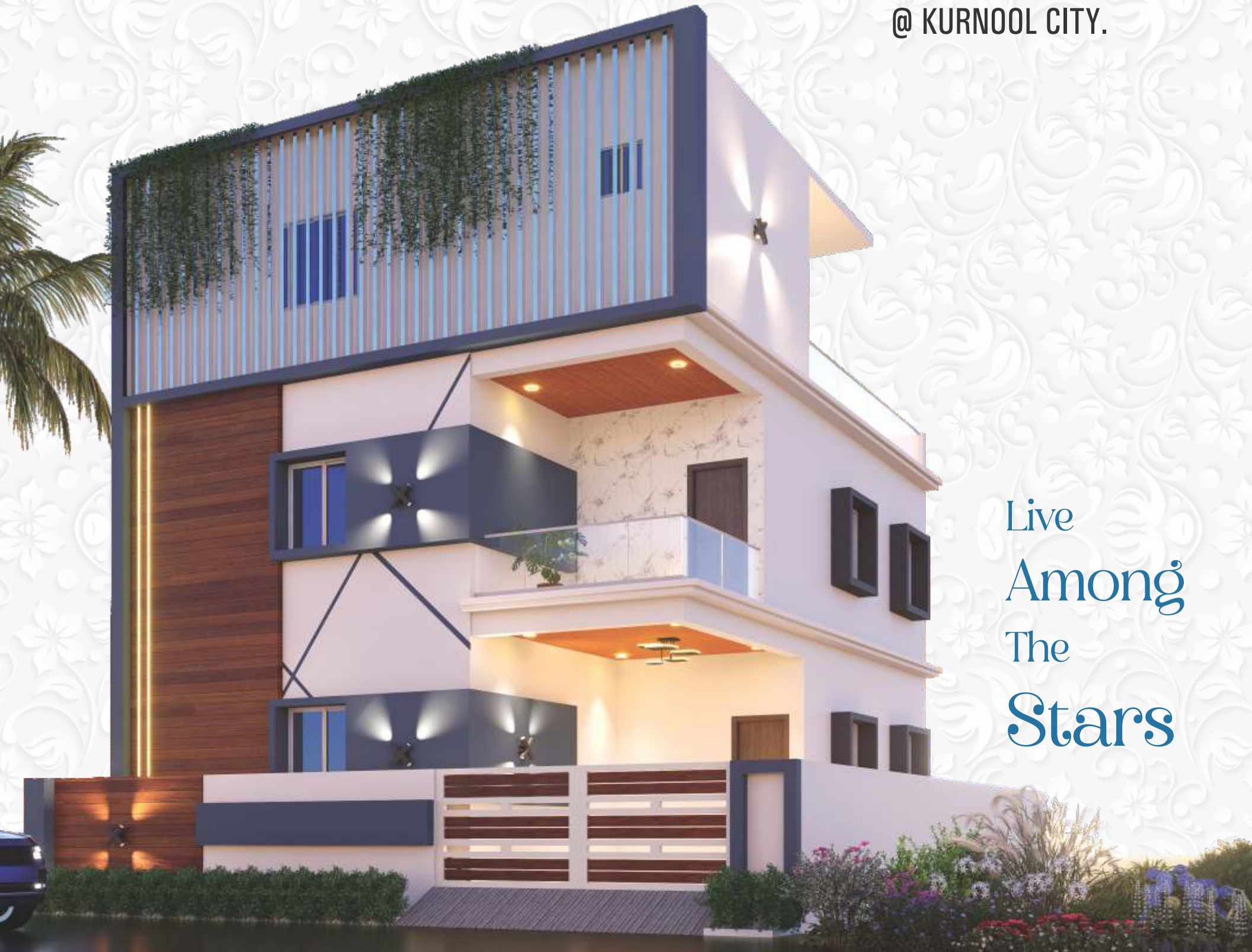

Live
 Among
 The
 Stars

Our Joint Projects:

JB
 BUILDERS & REALTORS
 Project By:

NEW SNEHA
 BUILDERS & DEVELOPERS



SCAN TO LOCATION

CREDAI

CONTACT:

Office Address:
 Shop No.:229 & 240, 2nd Floor,
 Jagadeesh Shopping Mall,
 KURNOOL - 518002.

EAST FACING VILLAS STREET VIEW

“Owning a home is a keystone of wealth... both financial affluence and emotional security.”

Dream Valley
Triplex Villas

IF YOU EVER BELIEVED IN THE

Beauty OF YOUR
Dreams...



Presenting

New Sneha Builder & Developer
Indeed a refined manifestation of
your delightful dreams,
this stunning work of art fulfills
your aspirations which you thought
were ever so elusive.

You are invited to reach for the
stars on the wings of your dreams.



EAST FACING VILLA

*"Living your best life
 in our best
 Dream Valley Villas"*



Dream Valley
 Triplex Villas

EAST - FACING PLANS

Area Details

| Ground Floor (Sft.) | First Floor (Sft.) | Second Floor (Sft.) |
|---------------------|---------------------|---------------------|
| 1170 Sft. | 1170 Sft. | 457.50 Sft. |
| TOTAL SFT. | 2797.50 Sft. | |

PLOT AREA 39.0' X 45.0' - 17.55 Sft = 4.03 Cents

WEST FACING VILLA



WEST - FACING PLANS

Area Details

| Ground Floor (Sft.) | First Floor (Sft.) | Second Floor (Sft.) |
|---------------------|---------------------|---------------------|
| 1065 Sft. | 1095 Sft. | 457.50 Sft. |
| TOTAL SFT. | 2647.50 Sft. | |

PLOT AREA 39.0' X 45.0' - 17.55 Sft = 4.03 Cents

*"All I need is a
 Luxury Villas in
 Dream Valley"*

Project By:



NEW SNEHA
BUILDERS & DEVELOPERS

ARIAL VIEW OF TOTAL PROJECT

*Welcome to the heaven of
Styly and Luxury*

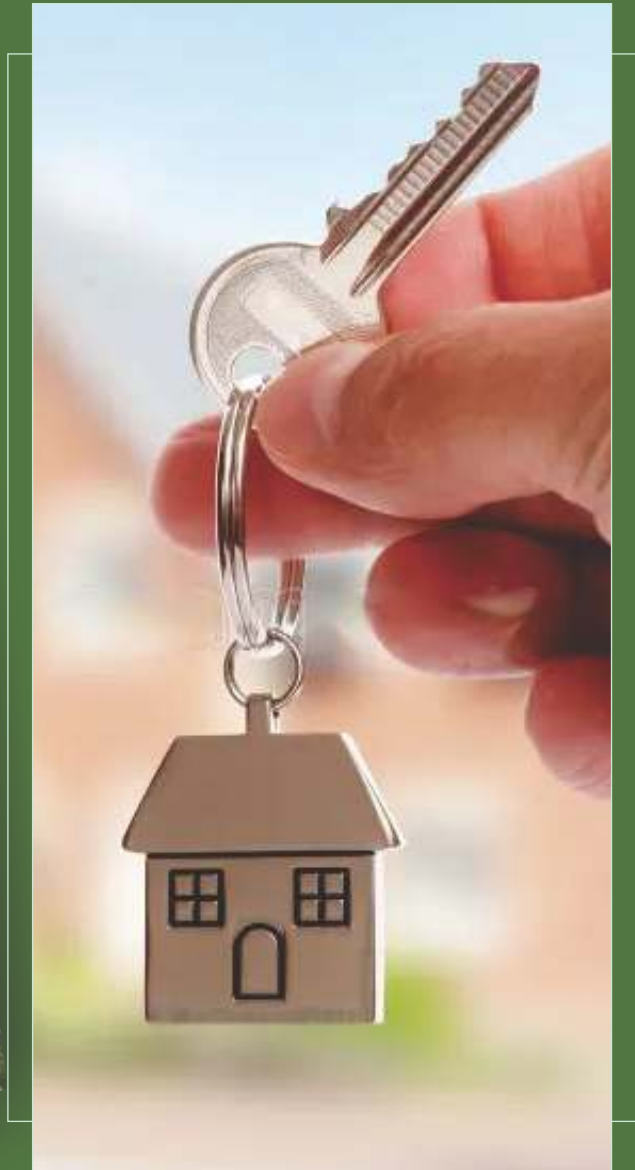

Dream Valley
Triplex Villas

NATURE CITY

LOCATION HIGHLIGHTS

- 2.5 km from Kurnool RTC Bus Stand
- Very Near to Kodumur Road, Opp. of Radio Station
- 100' & 60' Road Connecting
- Near by Many Educational Institutions & Hospitals
- City Municipal Limits

SITE FACILITIES

- Each Plot connected with Municipal Tap Water & Bore
- Street Lights
- BT Roads & Drainage
- Compound Wall
- Entrance Arch Gate with security
- Childrens Play Area

CLUB HOUSE

- Mini Function Hall
- Gym
- Snooker
- Super Market
- Guest Rooms



KURNOOL CORPORATION
 PLAN SHOWING THE RESIDENCIAL LAYOUT IN SY.No. 277 (P), 267/C, KALLUR (V) KALLUR (M) KURNOOL (DIST)

AREAS
 TOTAL SITE AREA : 2.45 ACRES
 TOTAL NO. PLOTS : 40
 ROADS : 30'

OWNERS

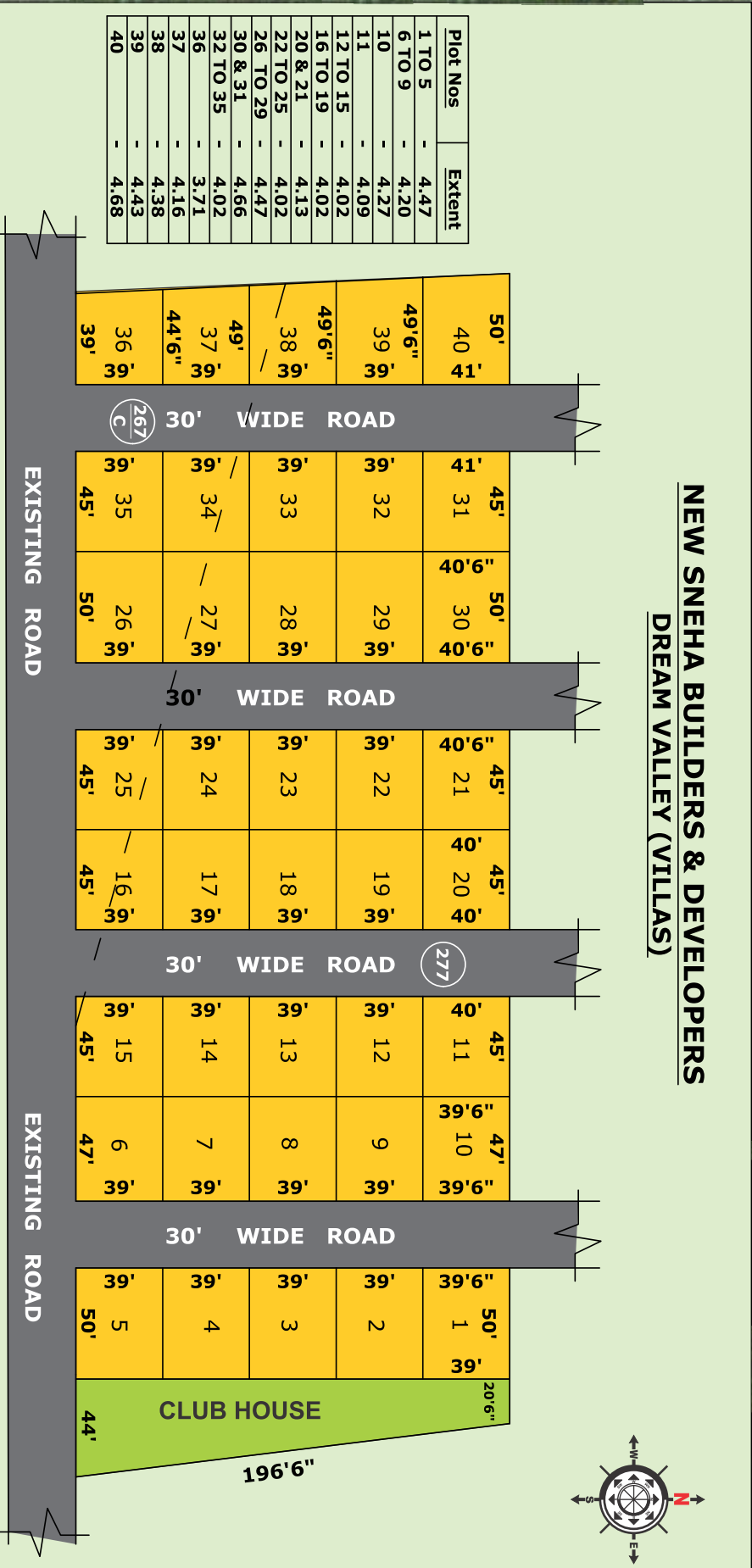

NEW SNEHA BUILDERS & DEVELOPERS
DREAM VALLEY (VILLAS)

CLUB HOUSE

PROJECT HIGHLIGHTS



SPECIFICATIONS DETAILS

- R.C.C. Work** : Framed structural Design.
- Superstructure** : Red Bricks in ALL Walls. (Light weight Bricks.) Plastering: Single coat with sponge finishing.
- DOORS** : Main Door Teak wood
- Bed Doors** : W PVC framed fitted with laminated flush shutters.
- Toilet Doors** : Water proof shutters.
- Windows** : UPVC window with two track sliding and mesh shutter.
- Ventilator** : Ventilated provision in toilets.
- Electrical** : Suitable points in each and every room. Wires: Anchor, Finolex, V-Gard. And any Brand. In All Bed rooms A/c and Gieser points provision. In Hall T.V. and Dish, and net points.

- Flooring:**
- Hall** : Granite big size.
- Toilets** : Wall Tiles Upto Door height tiles Flat form Granite with Steel sink. Dadoing 2'0" height
- Kitchen** : Flat form Granite with Steel sink. Dadoin 2'0" height.
- Plumbing** : All Bed Toilet: Wallmixer and shower. And E.WC. Common toilet: Single shower and tap, indian W.C.
- Hall** : one Wash Basin.
- Sanitary** : Standard ISI Mark pipes, 4" in toilet, 3" in bothrooms,
- Shelves** : M.Bed, C.Bed, Kitchen, and Hall 500 SFT Shelves given.
- Painting** : Internal inner two coats, Asian, or JSW paints, External exterior two coats Asian, or JSW paints Weather coat paint for external walls ASIAN or JSW PAINTS

NOTE:

Additions or Alteration in any mentioned specifications will be charged extra. Service Tax, Labour Cess, VAT, Electrical (Departmental) connection, CGST, SGST. And Registration charges, and Municipal water tap connection, and any other Govt., charges to be paid by the individual House Owner.

